

A photograph of a man and a young boy fishing on a wooden pier. The man, wearing a light-colored button-down shirt and shorts, is smiling and looking at the boy. The boy, wearing a light blue long-sleeved shirt and green shorts, is holding a fishing rod. They are standing on a wooden pier that extends over a body of water. In the background, there are other piers, a small building with a green roof, and a line of trees under a cloudy sky. The text '2025' is overlaid on the left side of the image.

2025

COMMUNITY HEALTH NEEDS ASSESSMENT



Beaufort Memorial



TABLE OF CONTENTS

- 3. About Beaufort Memorial
- 4. Health Status and System Responsiveness
- 5. Survey Assessment Process & Methodology
- 6. Demographic Overview
- 8. Results and 2025 Priorities
- 9. Addressing Access to Primary Care
- 11. Addressing Cost of Care
- 13. Addressing Obesity/Chronic Disease Management
- 15. 2022 Community Health Needs Assessment Update
- 19. Community Resource Toolkit
- 20. Community Partners

About Beaufort Memorial

Beaufort Memorial, a not-for-profit hospital founded in 1944, is licensed for 201 beds (169 acute, 14 rehabilitation and 18 mental health). We are an acute-care hospital, a regional referral center and the largest medical facility between Savannah, Ga., and Charleston, S.C.

Fully accredited by The Joint Commission, Beaufort Memorial boasts a dedicated, high-quality medical staff of nearly 320 board-certified or board-eligible providers. The hospital system includes 32 physician practices, one cancer centers and three Express Care & Occupational Health clinics to serve residents of the Lowcountry.

As the region's sole community hospital, our mission is to enhance the quality of life in the Lowcountry through improved health, innovative partnerships and superior care. As part of that mission, Beaufort Memorial continues to expand access and enhance high-quality care we provide.

It has been a year of strategic, smart growth: we cut the ribbon on the Beaufort Memorial Career Development Center, which houses the ever-growing and evolving People Achieving Their Highest (PATH) program and acts as a satellite location for the University of South Carolina Beaufort (USCB) Nursing Program.

We're continuing to invest in our employees, offering creative solutions to tackle widespread challenges like affordable, reliable childcare and workforce housing – two projects that saw exciting milestones this year with the relocation of the Learning Center to the hospital's main campus in Beaufort and our partnership with the Town of Bluffton and Beaufort County for an affordable housing project that is months away from breaking ground in the southern part of the county.

The needs of this diverse area continue to evolve, and the addition of a board-certified, fellowship-trained plastic surgeon has allowed us to expand reconstructive care options at Beaufort Memorial for breast cancer survivors – and implement cutting edge technology.

Throughout the Lowcountry, Beaufort Memorial is taking action, with multiple construction projects that, when complete, will expand critical healthcare access into locations that are convenient for all of our patients. We are continuing to forge exciting partnerships, transforming the way healthcare is delivered in this region.



Health Status and System Responsiveness

Beaufort County consistently ranks among the top counties in South Carolina for health outcomes and health factors. Residents report higher levels of overall health and well-being compared to state averages, and the county has met or exceeded several national benchmarks in public health indicators.

Despite these rankings, the county faces ongoing challenges. Rising rates of preventable chronic diseases, coupled with an aging population, underscore the need for continued focus on prevention, early detection, and intervention.

Beaufort Memorial Hospital (BMH) has played a fundamental role in expanding access to care. Over the years, BMH has grown its services and geographic reach to meet the needs of a growing population. Recent expansion and renovations include:

- Breaking ground on a 28-bed hospital in Bluffton, expected completion early 2027
- Acquisition of Island Imaging Center on Hilton Head Island
- Combination Emergency Room and Urgent on Hilton Head Island, expected completion early 2026
- Land acquisition at May River Crossing in Bluffton for a medical office building to include Primary Care
- Renovation and expansion of Lady's Island Internal Medicine and Lowcountry Medical Group in Beaufort
- Surgical pavilion renovation and expansion adding 2 additional Operating Rooms and a new Endoscopy Suite and Sterile Processing Suite at Beaufort Memorial Hospital
- Addition of a Crisis Stabilization Unit in the ER at Beaufort Memorial Hospital
- New Angiography Suite at Beaufort Memorial Hospital
- New Cath Lab at Beaufort Memorial Hospital

The strategies and implementation plan which evolved from this assessment process attempts to balance the community's identified priorities with endeavors that are fiscally sound and in keeping with BMH's commitment to the individuals of Beaufort County.



Survey Assessment Process & Methodology

To obtain data for the Community Health Needs Assessment (CHNA), a structured, multi-step methodology is employed to ensure the collection of reliable, representative, and actionable information. The process begins with the design of a comprehensive, evidence-informed survey instrument, developed in consultation with public health professionals and aligned with established health indicators. The survey includes both quantitative and qualitative questions that assess key areas such as access to primary care, health behaviors, chronic disease prevalence, mental health status, and social determinants of health (e.g., housing, transportation, and food security).

Once finalized, the survey undergoes pilot testing with the CHNA committee to refine question clarity, flow, and relevance. Following revisions, the final survey is distributed through a multimodal dissemination strategy to ensure broad community reach. Digital distribution includes targeted email campaigns to active patient lists, promotion through healthcare system websites and social media platforms, and sharing through trusted community-based organizations, faith groups, and local government networks. To ensure inclusion of non-digital populations, printed surveys are made available in high-traffic community locations and through partner organizations. Spanish-language versions are also provided, and responses collected on paper are manually entered and validated for accuracy.

To encourage participation, clear messaging is provided regarding the purpose of the survey, its importance for future health planning, and assurances of confidentiality and anonymity. The anonymous format promotes open, honest feedback without fear of repercussion.

After the data collection window closes, all responses are aggregated and analyzed using both descriptive statistics and thematic coding for open-ended responses. The data is then stratified by key demographic variables (e.g., age, race/ethnicity, geography) to identify disparities and trends. The resulting insights are synthesized to highlight unmet needs, service gaps, and priority areas, and are used to inform community health improvement strategies, resource allocation, and collaborative planning efforts.



Demographic Overview

As of 2025, Beaufort County has an estimated population of 204,643, making it the 10th largest county in South Carolina. The county has seen significant growth in recent years, a 25.67% increase since 2010, driven in part by its appeal to retirees, military families, and coastal lifestyle seekers.

Approximately 24% of residents are over the age of 65, compared to 18% statewide, highlighting the county's aging population and increased demand for chronic disease management, rehabilitation, and preventive care services.

In developing the 2022 Community Health Needs Assessment (CHNA), the Beaufort Memorial CHNA committee noted a similar demographic breakdown in survey responses. However, despite efforts to ensure broad representation, a large portion of responses came from Beaufort Memorial's active patient email list, which skewed the sample toward certain populations. In response, the committee made intentional efforts to reach a more diverse and representative group of respondents through targeted outreach and community partnerships.



Demographics		Beaufort County	Survey Participants
Race	White	70%	92%
	Black	16%	6%
	Bi- or Multi-Racial	7%	0%
	Other	7%	2%
Ethnicity	Hispanic or Latino	12%	2%
Age	Under 15 Years	15%	1%
	15 to 29 Years	18%	3%
	30 to 64 Years	39%	15%
	65 to 84 Years	25%	76%
	85 Years and Older	3%	5%

Results & 2025 Priorities

The goal of this assessment is to engage community members and systematically identify and analyze the health needs of our community.

Through input gathered from residents and key stakeholders, the 2025 Community Health Needs Assessment (CHNA) serves as a foundation for developing targeted strategies, programs, and policies aimed at promoting health equity and improving overall community well-being.

This year's assessment received 3,333 responses (N=3,333), an increase of 2,116 responses compared to the 2022 survey, reflecting a significant rise in community engagement. The Beaufort Memorial CHNA Committee conducted a thorough analysis of the data. The top three health needs identified by respondents were:

1. Access to Primary Health Services
2. Cost of Health Care Services
3. Obesity and Chronic Disease Management

These priorities were consistently emphasized throughout the survey, signaling their critical importance to the community.



Expansion and Recruitment

To meet the evolving healthcare needs of a rapidly growing population, Beaufort Memorial has made significant investments in provider recruitment and service expansion across the region. Since 2022, the organization has more than doubled the number of new providers added annually, increasing from 11 in 2022 to 23 by 2025. This growth reflects a strategic focus on enhancing access to care in both primary and specialty services.

Several major facility developments are also underway to support this expansion. The Bluffton Community Hospital, currently under construction, will bring essential inpatient and outpatient services closer to one of the fastest-growing areas in Beaufort County. Additionally, the May River Crossing Primary Care location will open with four new primary care providers, improving access to preventive and chronic care management in the Bluffton-Hardeeville corridor.

On Hilton Head Island, construction will begin in late 2025 on a new Combination Emergency Room and Urgent Care in partnership with Intuitive Health and MUSC Health. This facility will combine the capabilities of an emergency room and convenience of an urgent care with the pricing based on the level of care necessary.

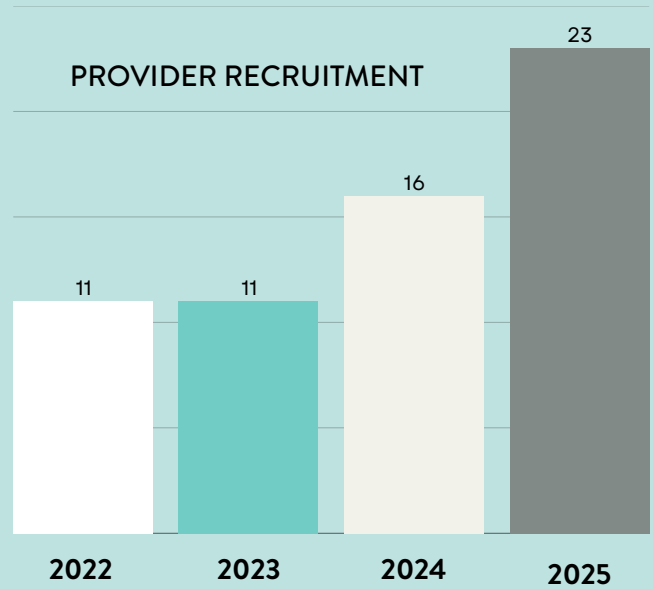

Together, these efforts represent a coordinated approach to addressing critical gaps in care, reducing geographic barriers, and ensuring timely access to quality health services for residents across Beaufort County and the surrounding region.

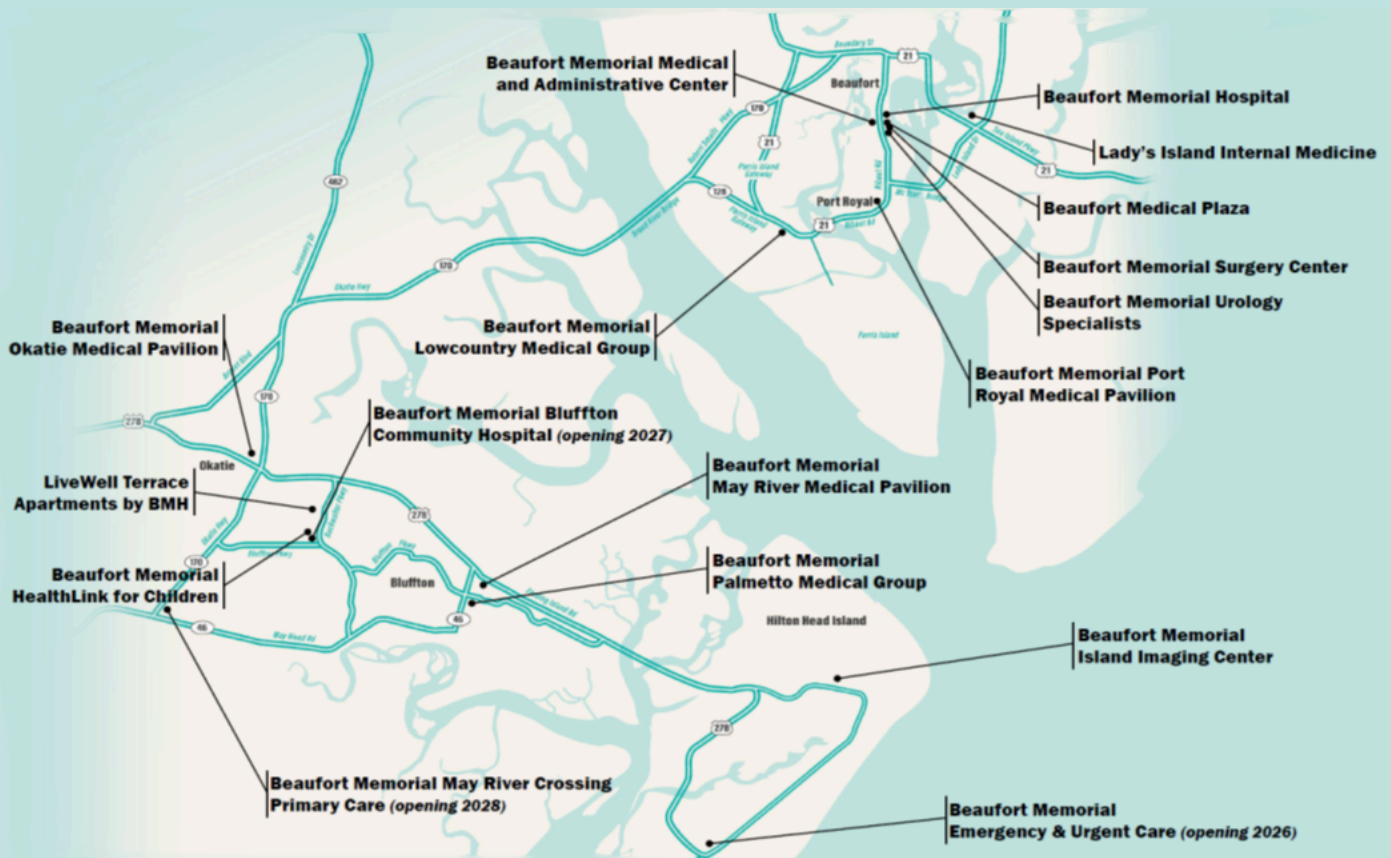

Education and Training

Beaufort Memorial offers a range of workforce development and clinical education initiatives through its PATH (People Achieving Their Highest) program, designed to support career advancement within the healthcare field. The PATH program includes structured training sessions utilizing coursework developed by the National Healthcareer Association. These sessions prepare participants for certification in various healthcare roles, including phlebotomy, clinical medical assisting, nursing assistance, patient care technology, and electrocardiogram (EKG) technology. Instruction is delivered by Beaufort Memorial's Education Department staff and includes a combination of classroom learning, skills labs, and supervised on-the-job training.

Participants pursuing a long-term path in nursing or allied health professions are encouraged to enroll in accredited institutions such as the University of South Carolina Beaufort (USCB) or Technical College of the Lowcountry. Tuition assistance is available through the PATH program in the form of scholarships, and staff may also access organizational discounts on tuition. In addition, Beaufort Memorial employees have access to no-cost continuing education opportunities through the Lowcountry Area Health Education Centers (AHEC).

In support of these initiatives, Beaufort Memorial opened the PATH Career Development Center in July 2024. Located on the hospital's main campus, the 6,340-square-foot, \$2.8 million facility was developed in partnership with USCB, the City of Beaufort, Beaufort County, and the Beaufort Memorial Foundation. The Center includes four simulation labs designed to replicate inpatient rooms at Beaufort Memorial Hospital, each outfitted with high-fidelity manikins for realistic clinical training. The facility also houses classrooms and skills training areas used for both workforce development programs and academic partnerships.

As part of its partnership with USCB, the Center began serving as a satellite location for the university's nursing program in August 2025. The first cohort included 24 sophomore nursing students, who now receive instruction and simulation-based training at the PATH Career Development Center. These students, many of whom come from Beaufort, Bluffton, and surrounding areas, selected the site specifically to gain immersive experience in a real clinical setting. With this additional instructional location, USCB aims to increase its annual number of nursing graduates from 42 to 72, directly supporting the regional healthcare workforce and expanding access to primary care by helping to meet the growing demand for qualified providers and support staff in our region.



Combination Freestanding ED and Urgent Care

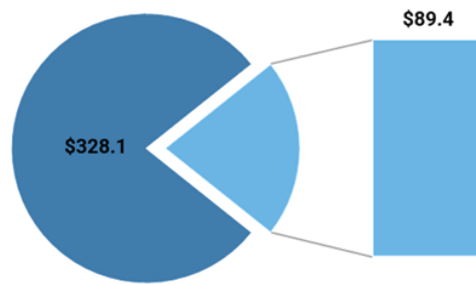

Annual US Healthcare Spend on Avoidable Emergency Care (\$ in billions)

Beaufort Memorial, in partnership with Intuitive Health and MUSC Health, will begin construction on a new combination Freestanding Emergency Department (FSED) and Urgent Care center on Hilton Head Island in late 2025.

This innovative facility is designed to address a growing need for more efficient, accessible, and cost-effective emergency care. According to a 2023 study by Intuitive Health, \$89.4 billion is spent annually in the U.S. on avoidable emergency room visits. In fact, nearly 30% of ER visits could be appropriately handled in an urgent care setting. By leveraging a dual-model approach, this combination facility can save an average of \$1,800 per visit.

Beaufort Memorial Emergency & Urgent Care will combine the advanced capabilities of an emergency room with the affordability and convenience of urgent care, all under one roof. Every patient will be evaluated by a physician trained in emergency medicine. If emergency-level treatment is not needed, the patient will receive care at the urgent care level and receive a bill that reflects that level of service.

The facility will feature on-site lab services and a state-of-the-art imaging suite equipped with X-ray and multi-slice CT scanners. With walk-in access, reduced wait times, and a streamlined approach to care, patients can expect to save time, money, and gain peace of mind—all without sacrificing the quality of care.

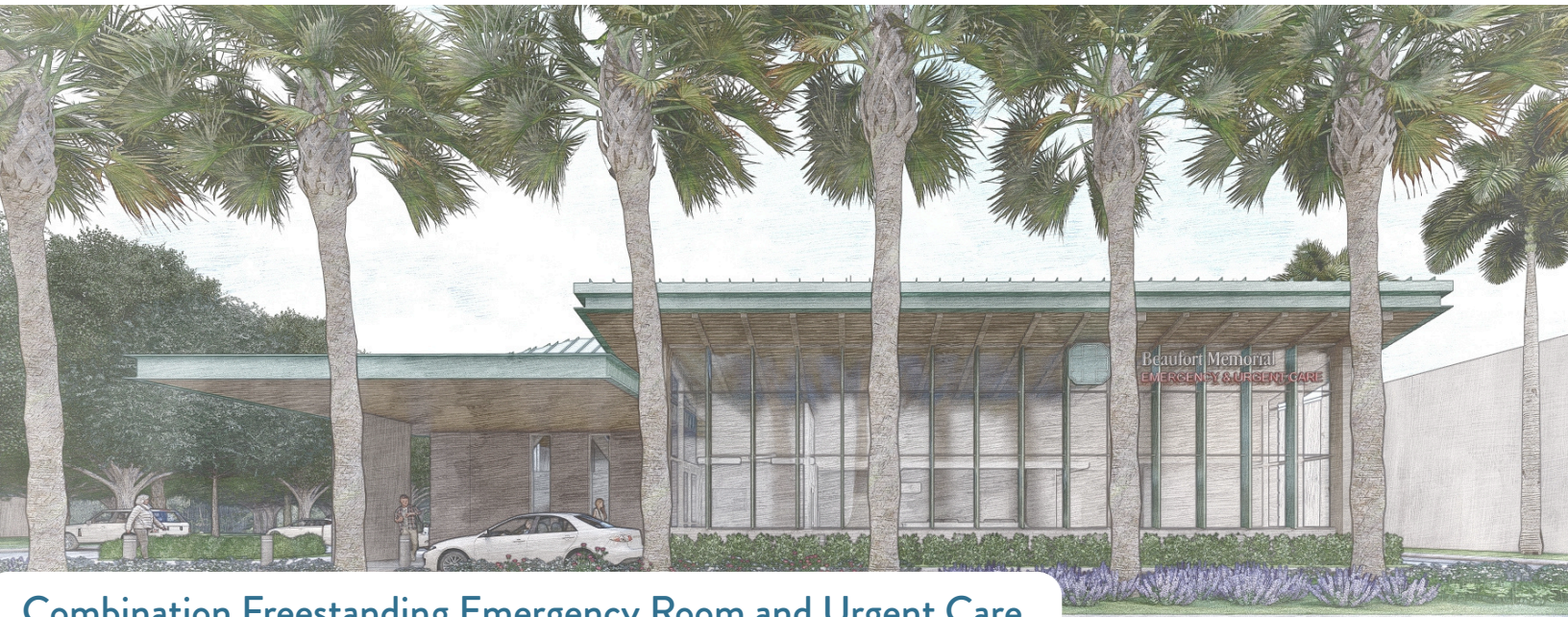

Combination Freestanding Emergency Room and Urgent Care

Direct Primary Care

Beaufort Memorial Direct Primary Care (DPC) provides members with access to a wide range of essential medical and preventive services for a low monthly membership fee. These services include annual physicals and women's health exams, in-person or telemedicine visits, routine lab work, electrocardiograms (EKGs), and annual flu vaccinations.

Designed to improve access to primary care and support long-term wellness, DPC allows members to receive care for short-term (acute) illnesses, manage chronic conditions, and focus on preventive care, all in one convenient setting. Visits can be scheduled in advance, and limited same-day appointments may be available with a phone call.

Beaufort Memorial also partners with contracted businesses to offer Direct Primary Care memberships to their employees and eligible family members. Memberships can be extended to employees, regardless of full-time or part-time status, and their covered dependents age 13 and older, provided they are not enrolled in Medicare, Medicaid, or Tricare. There are no income limits for participation.

By making routine care more accessible and affordable, Direct Primary Care helps reduce unnecessary emergency room visits, improve chronic condition management, and promote healthier lifestyle choices for individuals and families in our community.

Other initiatives and partnerships:

- Financial Assistance Program
- AccessHealth Lowcountry
- Good Neighbor Medical Clinic
- Volunteers in Medicine
- MDSave



LifeFit Wellness Services

At Beaufort Memorial, our mission is to improve the health of our community. As a healthcare leader in the Lowcountry, we are deeply committed to supporting programs, partnerships, and initiatives that promote healthy living and expand access to care for everyone.

Through services like the LifeFit Wellness Center, we empower individuals to take control of their health with personalized fitness, nutrition, and wellness programs. LifeFit also offers specialized services including Cardiopulmonary Rehabilitation and Adult Outpatient Rehabilitation, helping patients recover, regain strength, and return to their daily lives with confidence and support.

Our Mobile Health Unit extends care beyond hospital walls, delivering vital health screenings, medical services, and health education directly to underserved neighborhoods. By reducing barriers to care, we're reaching those who need it most, where they live.

LifeFit Wellness Center Offerings:

- Personal training and wellness coaching
- Cholesterol testing
- Blood pressure checks
- Blood glucose screenings
- Cardiopulmonary exercise testing and rehabilitation
- Body composition analysis
- Delay the Disease-Parkinson's disease-management exercise class
- Disease risk assessment
- Coronary artery calcification scanning
- Cardiovascular training
- Nutrition counseling from registered dietitians
- Vascular screening
- Cancer recovery
- Vascular rehabilitation

Community Health and Mobile Wellness Unit Offerings:

Free services include:

- Blood pressure checks for hypertension
- Blood sugar checks for diabetes
- Clinical breast, prostate and skin cancer exams (available only when a nurse practitioner is present)

Low-cost (\$10) Screenings:

- Prostate-Specific Antigen (PSA) blood test that accompanies the prostate exam
- Lipid profile to check cholesterol levels

Physician-Supervised Weight Management Program

Obesity is a disease that affects more than one-third of U.S. adults. It is not solely the result of a person eating too much and moving too little; it's a far more complex issue.

If you are overweight and have had limited success with diets, Beaufort Memorial's Healthy Weight program may be just what you need to drop the weight and regain control of your health.

Led by board-certified obesity medicine specialist Dr. Yvette-Marie Pellegrino, Healthy Weight takes a holistic approach to achieving and maintaining a healthy weight using nutrition, exercise, behavior and medication.

This program can also help to decrease the risk of complications and improve recovery from a surgery to repair worn joints, a hernia or another obesity-related condition.

Your 24-week Healthy Weight program includes:

- Personal, one-on-one guidance from board-certified obesity medicine specialist Dr. Yvette-Marie Pellegrino
- Comprehensive, individualized prescriptions for nutrition, exercise, behavioral modification and medication (if deemed necessary)
- One 1-to-2-hour initial visit with Dr. Pellegrino to review your history, do a physical exam and develop your plan
- Twelve physician visits to monitor your progress, help you overcome obstacles and make any needed plan adjustments
- Seven private sessions with a registered dietitian (up to 14 for Medicare beneficiaries)
- Guided use of the free MyFitnessPal app to monitor your nutrition

Dietitians and Diabetes Education

Since 2000, the Beaufort Memorial Diabetes Self-Management Program has held the American Diabetes Association's Education Recognition Certificate, meeting national standards for quality diabetes care.

The program is offered at the LifeFit Wellness Center in Beaufort and the Okatie Medical Pavilion, where patients work with diabetes educators to learn how to manage blood sugar, take medications, stay active, and prevent complications. These educators, who are also registered dietitians, provide expert guidance on nutrition, including meal planning, carb counting, and reading food labels.



Strategy 1: Beaufort Memorial will support current initiatives and promote new solutions to address healthcare costs.

New Solution: Beaufort Memorial has implemented a direct primary care clinic to support under and uninsured individuals. This program launched specifically targeting the hospitality industry, partnering with community organizations such as the Beaufort Area Hospitality Association (BAHA). The program has expanded to enhance employer benefit offerings to address not only healthcare costs for individuals but employers as well.

In addition to the 3 express care clinics spanning Beaufort County, Beaufort Memorial is constructing a new facility that is an innovative new model implementing a combination freestanding emergency room and urgent care on Hilton Head Island. This is one of the first of its kind in South Carolina, allowing patients to receive the appropriate care at the appropriate price.

Current Initiatives: Beaufort Memorial continues to offer financial assistance programs, supports AccessHealth of the Lowcountry in providing free specialty and primary care, supports the Good Neighbor Medical Clinic, partners with the Volunteers in Medicine on discounted services, and continues to apply for grants to help subsidize programs such as the patient transportation and sickle cell programs.



Strategy 2: Beaufort Memorial will support innovative chronic disease management programs.

Beaufort Memorial continues to advance its commitment to chronic disease prevention and management through expanded wellness and rehabilitation services. Cardiac and pulmonary rehabilitation offerings have grown significantly in Southern Beaufort County, while Northern Beaufort County benefits from a comprehensive program rooted in the LifeFit Wellness Center. In addition to rehab services, LifeFit provides medical nutrition therapy, personalized exercise prescriptions, group fitness classes, Parkinson's exercise classes and support groups, and access to the Mobile Wellness Unit, which delivers free and low-cost health screenings directly to the community.

While LifeFit Wellness Services have not yet expanded South of the Broad, Beaufort Memorial remains attentive to patient and community feedback, and is actively exploring opportunities to partner with local businesses to extend similar services to that area.

Effective chronic condition management starts with early detection and proactive care. We recognize the critical role education, regular screenings, and preventive appointments, such as annual physicals, mammograms, and OBGYN visits, helping to identify risk before they escalate. Through patient education, consistent communication, and strong provider-patient relationships, Beaufort Memorial is working to ensure that every individual is empowered to take charge of their health. Encouraging routine preventive care is a key part of our strategy to reduce the long-term impact of chronic diseases in our community.



Strategy 3: Beaufort Memorial will expand and support mental health services in Beaufort County.

Implementation Activities:

Beaufort Memorial is currently undergoing a \$1.9 million construction project in the emergency department to implement a Crisis Stabilization Unit designed to provide a safe and supportive environment for individuals facing a mental health crisis and in need of emergency care. Beaufort Memorial applied for and was granted funds from South Carolina Department of Health and Human Services (SCDHHS) to assist with the build out of this unit, with the results of this survey largely supporting the need for this service. This is over a \$1 million investment into mental healthcare services for the community. The Crisis Stabilization Unit will enhance the current mental health offerings, to which include the only 18-bed in patient unit in Beaufort County and an expanding outpatient practice that has expanded by two providers since 2022.



Strategy 4: Beaufort Memorial will continue to increase access to healthcare services and education.

Implementation Activities:

Access: Beaufort Memorial has 7 primary care locations, 3 express care and occupational health facilities, 1 direct primary care clinic and 2 more planned emergency rooms spanning Beaufort County focused on addressing the need for primary care services. There have been 60 providers recruited to BMH from 2022-2025.

Education: In January 2023, Beaufort Memorial implemented Social Determinants of Health screenings for all adult inpatient admissions 18+. A resource toolkit was created highlighting various community resources and is now provided to patients who screen positive for one or more of the areas screened. Community health education continued to be a priority and is supported through the speaker's bureau, community health Mobile Wellness Unit, and the Well at Work program with all meet the different needs of a diverse community. Examples of these education opportunities include regular, free-to-attend seminars led by experts in topics like orthopedics, breast health, cancer, access to care and nutrition, as well as frequent informational features in local print and broadcast media outlets.





Housing and Utility

Bluffton Self Help • 843-757-8000
Services: Emergency rental and utility assistance, security deposit help and more.

Beaufort-Jasper Economic Opportunity 843-255-7220
Services: One time rent help, referrals to section 8 rental subsidies, low income apartments and more.

South Carolina Housing Search 877-428-8844
Services: Resources for rent and utility deposits, access to housing programs.

Help of Beaufort • 843-524-1223
Services: Financial aid for energy costs, rent, food and other aid.

Beaufort County Housing Authority 843-525-7059
Services: Section 8 housing vouchers, public housing, rental programs and access to housing programs.

Navy-Marine Corps Society • 843-228-7357
Services: Help veterans and military members with housing assistance.

Consumer Credit Counseling • 912-691-2227
Services: Housing counselor for mortgage and foreclosure assistance programs.

Salvation Army Family Services 843-524-3727
Services: Rent, utility or eviction assistance. Free or low-cost furniture may be available.

Deep Well Project • 843-785-2849
*Hilton Head Only • Services: Assistance with moving costs, back rent to stop eviction, potential emergency lodging, home and septic system repairs, fund for water and utility bills.

United Way of the Lowcountry HELPLINE (Beaufort & Jasper) • 843-524-4357
United Way of Bamberg, Colleton and Hampton • 843-549-9594
Services: Community assistance referrals for basic needs

Project Cool Breeze • 843-377-2833
Services: AC unit or fan provided June – early September.

Under One Roof • 843-781-6770
Services: Repair and/or modify home for low income clients.

Affordable Connectivity Program (ACP) 877-384-2575
Services: Free and low cost internet with participating providers.
Application link: nv.fcc.gov



Interpersonal Safety

SC Child and Adult Protection Hotline 888-CARE4US • 888-227-3487

National Suicide and Crisis Lifeline - Call 988 or 800-273-TALK (8255)

SC Dept of Mental Health Mobile Crisis Line 833-364-2274

National Domestic Violence Hotline 800-799-7233 or Text START 88788

Coastal Empire Mental Health Crisis Line (afterhours) • 800-922-7844

Child Abuse Prevention Association (CAPA) 843-524-0281
Services: Child abuse prevention family resources • capabeaufort.org

Hopeful Horizons • 843-770-1070
Services: children's advocacy, domestic violence and rape crisis center.
hopefulhorizons.org

Family Promise of Beaufort County 843-815-4211
Services: Shelter program for families
familypromisebeaufortcounty.org



Transportation

Palmetto Breeze Transit 843-757-5782
Services: Free and low cost transportation

Medicaid Transport (ModivCare) 866-445-9954 • Services: Transportation for medical appointment. Need to have Medicaid. Call three days before the appointment to schedule. Call 24 hrs ahead to cancel.



Military Resources

Military and Family Support Center
militaryonesource.mil and enter your personal information



Beaufort Memorial



Food Pantries & Assistance

Beaufort • Port Royal • St. Helena Island

Praise Assembly of God • 800 Parris Island Gateway • Beaufort • 843-525-1121

HELP of Beaufort • 500 Charles St. • Beaufort 843-524-1223

Free Born Deliverance Temple • 113 Broad River Rd. Beaufort • 843-986-0840

New Hope Christian Church • 67 Parris Island Gtwy. Beaufort

Community Bible Church of Beaufort • 638 Parris Island Gtwy. • Beaufort • 843-525-0089

Bethel Deliverance Temple • 239 County Shed Rd. Beaufort • 843-521-0720

Beaufort County Council on Aging • 1408 Paris Ave. Port Royal • 843-524-1787

Home-delivered meals

Franciscan Center • 85 Mattis Rd. • Saint Helena Island 843-838-3924

The food pantry can also offer eye glasses, financial aid, and clothing, including at Christmas

New Life Deliverance Temple • 112 Halifax Rd. St. Helena Island • 843-838-3221

Church of the Harvest • 39 Fripp Point Rd. St. Helena Island • 843-838-2119

Ridgeland

Jasper County Hunger Free Zone • 456 Grays Hwy. 843-645-9000

Anitoch Educational Center • 7557 W Main St. 843-645-9400

Food, Transportation, Utilities, Rent, Clothing

Community Long Term Care – Beaufort County 10175 S Jacob Smart Blvd. • 843-726-5353

Home-delivered meals

Jasper County Council on Aging - Ridgeland Senior Center • 444 Wise St. • 843-726-5601

Margaret F. Curtis Food Pantry • 2676 Bees Creek Rd. 843-717-2812

SC Dept of Social Services

Beaufort
905 Duke St.
843-255-6080

Jasper
10908 N Jacob Smart Blvd
843-726-7747

Hampton
102 Ginn Altman Ave
803-943-3641

Bluffton

Bluffton Self Help • 39 Sheridan Park Cir. • 843-757-8000

Church of the Cross • 15B Centre Dr • 843-757-2661

First Zion Missionary Baptist • 10 Robertson St 843-757-3129

Hilton Head Island

Sandalwood Community Food Pantry

114 Beach City Rd. • 843-645-0935

Hilton Head Island Deep Well • 80 Capital Dr. 843-785-2849

Holy Family Catholic Church • 24 Pope Ave. 843-785-2895 ext 222



Community Partners

This assessment could not have been successfully completed without the support and assistance of the organizations listed below. These organizations represent leaders and staff from the hospital, public health and social support organizations, schools and universities, and local businesses.

- United Way of the Lowcountry
- Beaufort Regional Chamber of Commerce
- Beaufort-Jasper-Hampton Comprehensive Health Services (BJHCHS)
- University of South Carolina-Beaufort
- Good Neighbor Free Medical Clinic
- Beaufort County Black Chamber of Commerce
- Greater Bluffton Chamber of Commerce
- Hilton Head Island-Bluffton Chamber of Commerce
- Bluffton Jasper Volunteers in Medicine
- AccessHealth Lowcountry
- Beaufort County Health and Human Services
- Coastal Community Foundation
- Beaufort County School District
- Technical College of the Lowcountry
- Amedysis Home Health Care
- LowCountry Legal Volunteers
- LowCountry Outreach

